

JIB SHEETS



June/July 2009

MTYC OFFICIAL NEWSLETTER



Melbourne Trailable Yacht Club Inc
Registration No A2058
Website: www.mtyc.yachting.org.au

MTYC COMMITTEE - 2009-2010

Commodore	Geoffrey Onions
Vice Commodore	Lloyd Graham
Rear Commodore	Ron Parker
Hon Secretary	Doug Whitby
Hon Treasurer	Jan Reeves
Safety Facilitator	Alistair Owens
Sailing Officers	Steve Holligan
	Peter Gheller
	Adrian Cassar
	Greg Hall
	Mark McLellan
Auditor	Darrell Reid
Newsletter Editor	Phil Monk

Calendar –The next few months			
	Date	MTYC Events	Location or Starting Point
AUGUST	Sat 8	BBQ and Port Night	Waterfront City Marina, Docklands Overnight by boat or come by car. See page 3 for details.
	Thur 13	Committee Meeting	Bells Hotel, South Melb. Dinner at 6:30pm Meeting starts 7:30 pm
	Sun 16	Winter Series Race 3 (2 races)	St Kilda Marina - Briefing 9:45am, Start 11:00am
SEPT	Thur 10	Committee Meeting	Bells Hotel, South Melb. Dinner at 6:30pm Meeting starts 7:30 pm
	Sun 20	Winter Series Race 4 (2 races)	St Kilda Marina - Briefing 9:45am, Start 11:00am

Cover picture – Luis Feliciano, concentrating hard to keep his Castle 650, *Laguna Starlet*, moving in light air during the first Winter Series Race

Refuge Cove
Wilson's
Promontory



Melbourne Trailable YC
Happy Hour, Barbecue Dinner,
Port & Crumpet Night (all in one!!!)
Saturday 8 August 2009

6:00pm onwards

Waterfront City Marina - "Harbour View Room"
BYO food, drinks, port & crumpets

Come by sea or by land

Sail up the river from St Kilda or Warmies

Book your berth at the Marina by email to: berthing@melbourne.vic.gov.au

or call the Marina Office on 9658 8738

The cost is \$35 per boat, payable on arrival before 5:00pm

Access to bathrooms and other marina facilities included

Or

Drive into Docklands and join us at the "Harbour View Room", Marina

Office, right near the big white tent

Further details: Contact Ron Parker 9527 8310

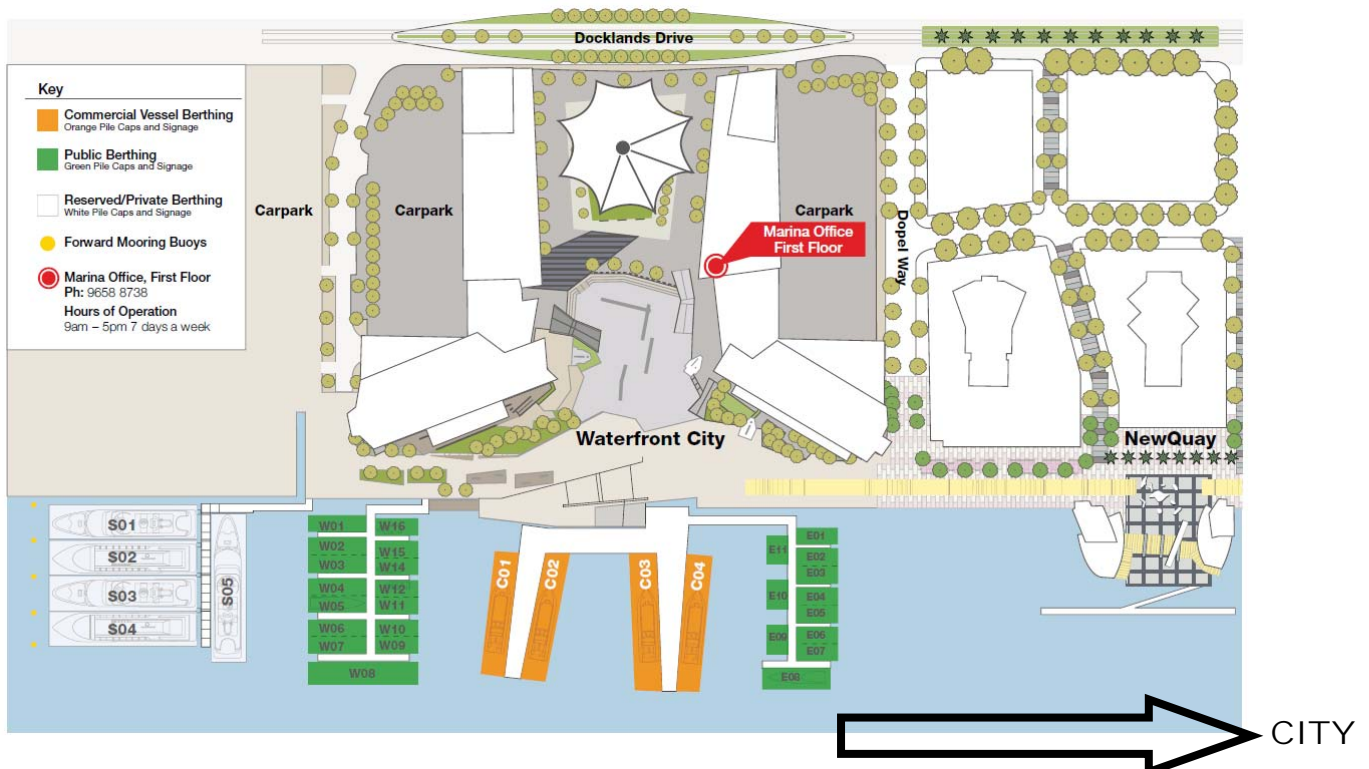

Commodore's Report

Geoff Onions

Presentation night was held on the 20th June and was well attended. The change of venue seemed to suit most. Trophies were awarded across all events and a range of competitors. However congratulations must go to Ron and Ruth on *Tainui* for cleaning up both the CBH Summer and Winter series. Thanks to Lloyd, Ron and Peter for setting up the slides and films shown throughout the night. For next year the committee will discuss other options for the catering to further improve the night. For the results for the season and photos of the night, refer to elsewhere in this addition.

The first of our winter races was held on the 21st of June, which attracted 10 starters, who enjoyed a great day's sailing. The race results are elsewhere in this newsletter.

The committee has decided, in order to further improve our boating safety, that by the commencement of this years Summer season, all competitors will be required to have VHF radios. This has been in a transition phase now for over a year and all members are now being given a final notice to ensure compliance. Please refer to a detailed article further in this newsletter. Several members are exploring in the idea of joining together in on a bulk VHF purchase to obtain the best discounts. Please email me if you are interested in a combined purchase. (email address on page 2)

Keep safe and enjoy your sailing over the winter months.

Geoff Onions
Commodore

Important Notice to MTYC Racers

The move to VHF radio

As of 1 October 2009, MTYC racing events will require yachts to have an operational VHF radio. 27Mhz radio will no longer be used in Club racing. The move towards VHF radio has been coming for sometime and the last 12 months or so has been a period of transition with the introduction of VHF radio being used in conjunction with 27Mhz. In recent years the interference from other users on 27Mhz has made effective race management very difficult.

For club events, in the interest of safety and risk management, it is essential that all boats are listening on the one type of radio.

MTYC races are sailed without external support. It is central to the Club's risk management and to the safety practices in our races that all boats are able to communicate with each other in case any boat needs assistance. This is why MTYC insists on a radio check prior to each race start. For this to be effective, all boats must have the same types of radios. This is now a VHF radio.

There are other great benefits for using VHF radio (whether racing or cruising including:

- Coast Radio Melbourne provides distress and safety monitoring on VHF Channel 16, 24 hours a day, seven days a week, with general coverage of Port Phillip and Western Port. It does not monitor 27 Mhz.
- Coast Radio Melbourne broadcasts weather forecasts for waters (including Port Phillip) on VHF 67 at: 0648, 1448 and 2048 EST. Weather warnings will be preceded by an announcement on Channel 16.
- Navigation warnings for waters in and around Port Phillip and Western Port are broadcast on VHF 67 and are rebroadcast after the weather.

Similar services are provided by volunteer organisations for example the Australian Volunteer Coast Guard at Sandringham and Paynesville provide weather and other information.

Other benefits:

- Very clear transmission with no interference from engines.
- No garbled conversations and yakkity yak from others.

For more information about the benefits and use of VHF radio, go to the website of The Office of Maritime Communications at the Australian Maritime College. It is responsible for the management of all functions associated with marine radio examinations and certification services in Australia. This includes the production and distribution of the Marine Radio Operators Handbook, production and distribution of examination papers and certificates.

Beautiful Refuge Cove

By Anne Holligan – *Silhouette*



The June long weekend saw four Melbourne Trailable yachts (*Tainui*, *Son-ia-tu*, *O'Really II* – all Noelex 25s and *Silhouette* an RL28) join with Port Albert Yacht club, under the leadership of Rob Davies in “Dragonfly”, for their annual cruise to Refuge Cove (Wilsons Prom.).

Melbourne Trailable yachts arrived at Port Welshpool during the Friday afternoon and evening, all in time to enjoy a meal and warm surroundings of the local hotel, which had been built to cater for passengers using the Catamaran to Tasmania (no longer running). Arriving in daylight, we were treated to a lovely sunset as a backdrop to Port Welshpool's historic long jetty.

Next morning the boat ramp park was a hive of activity as boats prepared for launching at the excellent facility with double boat ramp and adequate jetty room. It is quite a busy ramp as Port Welshpool is a popular fishing spot.



We had been watching the weather forecast all week and on Thursday it seemed we would be OK to go as moderate north westerlies were forecast for the weekend. Unfortunately by Saturday morning, as often happens, a front was arriving earlier resulting in a strong wind warning for Sunday and 30-35 knots on Monday. We decided to proceed with the cruise, planning our return for early Sunday. In retrospect we broke one of our “sailing rules” which is never to sail with a view to “beating” bad weather! (Steve and I knew we could stay in Refuge if we didn't feel comfortable about coming back.) You can now hear a weather forecast on the radio through a repeater station while inside Refuge, allowing safe planning.

After locking the cars and trailers at the local boat club, we left Port Welshpool under cloudy skies at about 10.30. After motoring out through the channel we put sail up and enjoyed a pleasant sail in 10-12 knot north westerlies with little sea. Everyone had lots of warm gear, so the sail was very pleasant with the rain holding off until it was time to anchor and set lines! Some boats anchored out with stern lines to limit swing while others put anchors onto the shore. We decided *Silhouette* probably had the most space for “happy hour” so 13 of us managed to enjoy drinks and tall stories while the rain continued to drizzle around us.



We enjoyed a peaceful and calm night at anchor with some crews getting more sleep than others but each to his own! After a soft sunrise next morning, everyone was up preparing to depart. Very quickly, before leaving, a few of us walked up the cliff above the anchorage to enjoy the panoramic view of this beautiful cove. It was a shame that the weather had restricted our hiking time. (Maybe next time)



We reluctantly pulled up anchor at about 9 am and with reefed sails started the gusty passage home. The wind

and sea were both a bit higher than we would have preferred and after a few miles we decided to motor sail, making the trip more comfortable and allowing us to prepare lunch. We were very fortunate that the rain held off all the way back to Port Welshpool.



The Noelexs made the best time crashing through the waves at a great rate! Arriving back at the jetty, we tied up and waited for Rob in Dragonfly to return and unlock the cars and trailers. With everyone assisting the boats were soon retrieved (we were lucky as the bad weather had kept the fishermen away) and soon after packing up began, so did the rain!

We had a short happy hour in a shelter nearby before we decided that the warmth of the hotel was more inviting and we were soon all sitting around a big table enjoying good food, good wine and great company. It had been a long day and most of us were ready for bed before too long.

Even though it had been a quick trip due to the limitations of the weather, we had enjoyed the majesty of Refuge for one evening and a morning, while enjoying great company and an enjoyable sail down.

Monday morning saw everyone packing up in their own time and leaving to make the very scenic journey home along the South Gippsland highway. By then the wind was "blowing a gale" so we knew we'd made the right decision to return early.

A wedding in the Club

Congratulations to two of our MTYC Members, the regular racing crew from *Monkey Business*, Jarrod Monk and Eleanor Lee, who were married on 18 July at the Melbourne Wedding Registry in the Old Treasury building.



For sale

Comet Trailable Yacht
6 Meter fibreglass

9.9 hp long shaft Yamaha O/B
Drop and swing bladed rudders. Swing keel
Pushpit / Pullpit and life lines.
Sails include Main, Jib, Genoa and Spinnaker.
Roller reefing. Mainsail cover
Fully lined interior.

Equipped for cruising (bunk cushions etc)
Gas/ Electric fridge 12 volt and 240 volt. Porta Potty
2 burner S/Steel Metho stove.
Fish finder/Depth sounder.
Uniden 27 Meg 10 channel radio
All safety gear, Life jackets, manual bilge pump,
flares
Dunbier trailer with spare wheel.

\$6600.00 O.N.O.

Darrell Reid

Phone 93361042

Mobile 0458 023 328

Email dejereid@iprimus.com.au

Notices to mariners
1 June 2009

The following are extracts from Notices issued by Gippsland Ports

PORT OF GIPPSLAND LAKES
INSTALLATION OF NEW NAVIGATIONAL LIGHT
MONTAGUE POINT - GIPPSLAND LAKES

DATE: Effective Immediately.

DETAILS: Mariners are advised that a new. navigational light has been installed in the Gippsland Lakes at the South West end of Raymond Island.

Montague Point West Cardinal mark lit
Characteristics: Qk Fl W(9) 10s

Lat :37° 55.415' S
Long:147° 43.151' E

PORT OF GIPPSLAND LAKES
INSTALLATION OF NEW NAVIGATIONAL LIGHT
DUCK ARM-GIPPSLAND LAKES

DATE: Effective Immediately.

DETAILS: Mariners are advised that a new. Navigational light has been installed in the Gippsland Lakes at Duck Arm.

Duck Arm Approach Port Hand mark lit :
Characteristic: Qk Fl R
Lat :37° 56.624' S
Long: 147° 41.141'E



Winter 09 – Race Held 21/6/09

Race 1 – Results on PHC					Race 2 – Results on PHC			
Boat Name	PHC	Elap	Corrected	Place	Boat Name	Elap	Corr	Place
No Excuses	0.693	1:32:20	1:03:58	1	No Excuses	0:56:10	0:38:55	1
Night Crossing	0.667	1:37:48	1:05:16	2	Tanina	1:01:23	0:41:38	2
Tanina	0.678	1:36:55	1:05:44	3	Night Crossing	1:02:57	0:42:00	3
Laguna Starlet	0.647	1:43:24	1:06:53	4	Tainui	0:58:16	0:42:14	4
Tainui	0.725	1:32:20	1:06:55	5	Liaison	0:59:56	0:43:19	5
Call Me Ishmael	0.725	1:33:30	1:07:47	6	Laguna Starlet	1:10:49	0:45:48	6
Liaison	0.723	1:34:21	1:08:11	7	Call Me Ismail	1:03:32	0:46:04	7
Sunray	0.620	1:52:34	1:09:47	8	Miss Scarlet	1:02:46	0:47:42	8
Miss Scarlet	0.760	1:36:05	1:13:01	9	O'Really II	1:09:30	0:50:23	9
O'Really II	0.725	1:44:46	1:15:57	10	Sunray	1:25:20	0:52:54	10

Combined - PHC

Boat Name	Skipper	Type	Place Race 1	Place Race 2	Combined Place points	PHC Combined Corrected	PHC Overall Place	PHC - Revised for Next race
No Excuses	Mark McLellan	Castle 650	1	1	2	1:42:53	1	0.709
Night Crossing	Peter Gheller	Noelex 25	2	3	5	1:47:16	2	0.673
Tanina	Roger Summerfield	Sonata 8	3	2	5	1:47:22	3	0.683
Tainui	Ron Parker, Ruth Eaton	Noelex 25	5	4	9	1:49:09	4	0.725
Laguna Starlet	Luis Feliciano	Castle 650	4	6	10	1:52:41	5	0.643
Liaison	Adrian Cassar	RL24 D	7	5	12	1:51:30	6	0.720
Call Me Ishmael	Alistair Owens	Castle 650	6	7	13	1:53:51	7	0.719
Miss Scarlet	Ron Van Der Heide	RL24 D	9	8	17	2:00:44	8	0.744
Sunray	Doug Whitby	TS16	8	10	18	2:02:42	9	0.603
O'Really II	Dennis Bromley	Noelex 25	10	9	19	2:06:21	10	0.698

Race 1 – Results on CBH				Race 2 – Results on CBH		
Boat Name	CBH	CBH Corrected Time	Place	Boat Name	CBH Corrected Time	CBH Place
No Excuses	.725	1:06:57	1	No Excuses	0:40:43	1
Tainui	.725	1:06:57	1	Tainui	0:42:15	2
Call Me Ishmael	.725	1:07:47	3	Tanina	0:44:30	3
Tanina	.725	1:10:16	4	Liaison	0:45:33	4
Night Crossing	.725	1:10:54	5	Night Crossing	0:45:38	5
Sunray	.630	1:10:55	6	Call Me Ismail	0:46:04	6
Liaison	.760	1:11:42	7	Miss Scarlet	0:47:42	7
Miss Scarlet	.760	1:13:01	8	O'Really II	0:50:23	8
Laguna Starlet	.725	1:14:58	9	Laguna Starlet	0:51:21	9
O'Really II	.725	1:15:57	10	Sunray	0:53:46	10

Combined - CBH

Boat Name	Skipper	Type	CBH Place Race 1	CBH Place Race 2	CBH Combined Places	CBH Combined Corrected	CBH Overall Place
No Excuses	Mark McLellan	Castle 650	1	1	2	1:47:40	1
Tainui	Ron Parker, Ruth Eaton	Noelex 25	1	2	3	1:49:11	2
Tanina	Roger Summerfield	Sonata 8	4	3	7	1:54:46	3
Call Me Ishmael	Alistair Owens	Castle 650	3	6	9	1:53:51	4
Night Crossing	Peter Gheller	Noelex 25	5	5	10	1:56:33	5
Liaison	Adrian Cassar	RL24 D	7	4	11	1:57:15	6
Miss Scarlet	Ron Van Der Heide	RL24 D	8	7	15	2:00:44	7
Sunray	Doug Whitby	TS16	6	10	16	2:04:41	8
Laguna Starlet	Luis Feliciano	Castle 650	9	9	18	2:06:18	9
O'Really II	Dennis Bromley	Noelex 25	10	8	18	2:06:21	10

Summer 08 09 - Series Results and Final Placings based on PCH

Boat Name	Skipper	Type	R1	R2	R3	R4	R5	R6	R7	R8	R9	R10	R11	Total with No drops	Total with 2 drops	Final Place	
Alicia II	Bob Reeves	RL24 S	11	4	0	9	11	9	9	0	11	3	14	81	56	10	
Almost Too	Colin Clark	Farr 6000	11	15	0	9	11	9	7	0	5	8	9	84	58	12	
Bluey	John Brooks	Young 5.2	11	15	0	9	11	8	8	0	11	8	14	95	66	17	
Colduck	Geoff Onions	RL24 D	1	3	0	5	4	9	3	0	4	1	8	38	21	2	Second PCH
Farr Affair	Martin Culkin	Farr 750	5	6	0	8	11	9	12	0	11	8	14	84	58	11	
Freedom	Morgan Fisk	Swarbrick 20	11	13	0	9	6	9	12	0	11	8	14	93	66	16	
Impulse	Malcolm Knight	Farr 750	11	15	0	9	11	9	12	0	7	8	10	92	65	15	
Laguna Starlet	Luis Feliciano	Castle 650	11	11	0	9	10	9	12	0	11	6	13	92	67	18	
Laissez Farr	Graeme Hobley	Farr 750	11	15	0	9	11	9	12	0	6	8	11	92	65	14	
Liaison	Adrian Cassar	RL24 D	7	7	0	6	11	5	12	0	10	4	2	64	41	7	
Mixed Nuts	Bob White	Magnum	11	15	0	9	11	9	12	0	11	8	14	100	71	21	
Monkey Business	Phil Monk	Farr 6000	11	1	0	9	9	7	10	0	9	8	5	69	48	9	
Night Crossing	Peter Gheller	Noelex 25	6	2	0	9	1	1	6	0	11	8	7	51	31	5	
No Excuses	Mark McLellan	Castle 650	11	15	0	9	7	6	5	0	11	8	1	73	47	8	
Sadagarous	Alistair Owens	Seaway 787	9	15	0	9	11	9	12	0	11	8	14	98	69	19	
Sunray	Doug Whitby	TS16	11	15	0	9	11	9	11	0	11	8	14	99	70	20	
Tainui	Ron Parker Ruth Eaton	Noelex 25	3	8	0	1	11	2	4	0	2	2	4	37	18	1	First PCH
Taipan	Merv Murphy	Hartley 24	2	5	0	7	2	4	2	0	3	8	3	36	21	3	Third PCH
Tanina	Roger Summerfield	Sonata 8	10	13	0	3	9	9	12	0	11	5	13	85	59	13	
The Sting	Lloyd Graham	RL24 D	4	9	0	2	5	3	12	0	1	7	6	49	28	4	
UnFarrGetable	Andrew Johnston	Farr 750	8	10	0	4	3	9	1	0	8	8	14	65	41	6	
		No of Starters	10	14	No Race	8	10	8	11	No race	10	7	13				

Series Results and Final Placings based on CBH

Boat Name	Skipper	Type	R1	R2	R3	R4	R5	R6	R7	R8	R9	R10	R11	Total with No drops	Total with 2 drops	Final Place	
Alicia II	Bob Reeves	RL24 S	11	5	0	9	11	9	6	0	11	4	14	80	55	10	
Almost Too	Colin Clark	Farr 6000	11	15	0	9	11	9	9	0	7	8	10	89	63	16	
Bluey	John Brooks	Young 5.2	11	15	0	9	11	8	5	0	11	8	14	92	63	15	
Colduck	Geoff Onions	RL24 D	4	3	0	3	4	9	3	0	4	2	7	39	23	4	
Farr Affair	Martin Culkin	Farr 750	5	6	0	8	11	9	12	0	11	8	14	84	58	11	
Freedom	Morgan Fisk	Swarbrick 20	11	13	0	9	3	9	12	0	11	8	14	90	63	14	
Impulse	Malcolm Knight	Farr 750	11	15	0	9	11	9	12	0	5	8	9	89	62	13	
Laguna Starlet	Luis Feliciano	Castle 650	11	11	0	9	10	9	12	0	11	7	13	93	68	19	
Laissez Farr	Graeme Hobley	Farr 750	11	15	0	9	11	9	12	0	8	8	11	94	67	17	
Liaison	Adrian Cassar	RL24 D	6	8	0	4	11	6	12	0	10	5	3	65	42	5	
Mixed Nuts	Bob White	Magnum	11	15	0	9	11	9	12	0	11	8	14	100	71	21	
Monkey Business	Phil Monk	Farr 6000	11	1	0	9	9	7	7	0	6	8	5	63	43	6	
Night Crossing	Peter Gheller	Noelex 25	9	9	0	9	5	2	10	0	11	8	8	71	50	8	
No Excuses	Mark McLellan	Castle 650	11	15	0	9	6	5	7	0	11	8	1	73	47	7	
Sadagarous	Alistair Owens	Seaway 787	8	15	0	9	11	9	12	0	11	8	14	97	68	19	
Sunray	Doug Whitby	TS16	11	15	0	9	11	9	11	0	11	8	14	99	70	20	
Tainui	Ron Parker Ruth Eaton	Noelex 25	1	2	0	1	11	1	1	0	1	1	2	21	8	1	First CBH
Taipan	Merv Murphy	Hartley 24	3	4	0	6	1	4	2	0	3	8	4	35	21	3	Third CBH
Tanina	Roger Summerfield	Sonata 8	10	13	0	5	9	9	12	0	11	6	13	88	62	12	
The Sting	Lloyd Graham	RL24 D	2	7	0	2	2	3	12	0	2	3	6	39	20	2	Second CBH
UnFarrGetable	Andrew Johnston	Farr 750	7	10	0	7	7	9	4	0	9	8	14	75	51	9	
		No of Starters	10	14	No race	8	10	8	11	No Race	10	7	13				

Mug Award Nominees 2009

David Edwards	Any doubts about David's culinary skills have been put to rest once and for all. His gourmet contribution to Happy Hour was a frozen dip. Say no more!
Eleanor	Was she brave or foolish when she agreed to sail with Blake on Spook?
Blake	We all know about a Le Mans start, but a Le Mans finish? We are not sure if he was looking for a short cut home or if he just wanted to attempt to break the land sailing record. Either way there are no prizes for mounting the bank in your boat and tangling the rig in the trees.
Greg Plum	Camouflage or sponsored by Bunnings? Greg was trying to look inconspicuous as he quietly sailed out to the start line. However, the foliage attached to his mast did not go unnoticed! There's a story there.
Lloyd Graham	He is renowned for his strength when pulling on ropes. He can always get the extra inch or two that nobody else can manage. Pity the halyard was not attached to the main sail when he yanked it up! There were no strong words said because Sue was happily climbing the mast to retrieve the halyard.
Ron Van der Heide	<p>There is a theme here. Ron wreaked havoc with his car. He managed to blow out a tyre and then proceeded to blow up his motor.</p> <p>The questions is ... was he sponsored by Whelan the Wrecker this weekend? In his well meant rescue attempt of the ill fated Blake and El on Spook, Scarlet Lady came close to nudging them further up the bank and into the trees. Perhaps he was really after salvage rights?</p> <p>Thank Goodness DHS reported that Kathryn and the girls returned home from Easter unharmed.</p>

And the winner is.....Well done Ron Van der Heide- a great effort from a new member.

New Boats in the Club

Alistair Owens has sold his Seaway 25 and bought a Castle 650
Call Me Ishmael

Dennis Bromley (used to be Lloyd's crew) has bought a Noelex 25
O'Really II

Marg Goddard has her Sonata 7 on the market and has bought a Noelex 25
Special Edition

In case you are wondering, "Call me Ishmael" is the opening line of the 1851 Herman Melville novel "Moby Dick".

Presentation Night – Trophy Winners

2008 Winter Series PHC

<p>1st Adrian Cassar <i>Liaison RL24</i></p> <p>2nd Ron Parker & Ruth Eaton <i>Tainui Noelex 25</i></p> <p>3rd Mark McLellan <i>No Excuses, Castle 650</i></p>	
--	--

2008 Winter Series CBH

<p>1st Ron Parker and Ruth Eaton <i>Tainui. Noelex 25</i></p> <p>2nd Mark McLellan <i>No Excuses, Castle 650</i></p> <p>3rd Adrian Cassar <i>Liaison RL24</i></p>	
---	--

Commodore's Cup

<p>1st Mark McLellan <i>No Excuses, Castle 650</i></p> <p>2nd Ron Parker & Ruth Eaton <i>Tainui Noelex 25</i></p> <p>3rd Adrian Cassar <i>Liaison RL24</i></p>	
--	--

Easter Classic 2009

<p>1st Phil Monk <i>Monkey Business, Farr 6000</i></p> <p>2nd Greg Plum <i>Second Wind, Hunter 19</i></p> <p>3rd Greg Hall <i>Viking Express, Castle 650</i></p>	
--	--

Easter Sternchaser 2009

1st Doug Whitby
Sunray, Hartley TS16

2nd Adrian Cassar
Liaison, RL24

3rd Greg Plum
Second Wind, Hunter 19



Summer Triangle Series 2008-09 PHC

1st Ron Parker & Ruth Eaton
Tainui. Noelex 25

2nd Geoff Onions
Colduck, RL24

3rd Merv Murphy
Taipan, Hartley 24



Summer Triangle Series 2008-09 CBH

1st Ron Parker & Ruth Eaton
Tainui. Noelex 25

2nd Lloyd Graham
The Sting, RL24

3rd Merv Murphy
Taipan, Hartley 24



A few of the happy Members
at Presentation Night



For Sale

Sonata 7 Trailable Yacht

Gannet 752

\$26,250 negotiable

Call Margaret

0419 383 997

This boat has everything working and is ready to sail. Many items are new or near new and had little use since replacement.

Trailer: Rebuilt and galvanised 2008 – override mechanical brakes, 13 inch wheels including spare with new light truck tyres. Powerwinch 712 electric winch, new light board.

Outboard: 2003 Mercury 8HP motor (27kg) with charging unit, 12 litre fuel tank. 40-50 hours, recently serviced, starts easily, drives boat well.

Sails: Fully battened Hooper mainsail - with slugs. 2nd mainsail. Genoa; Jib; Storm jib; Spinnaker.

Instruments: New Raymarine ST40 instruments; new Suunto compass, Autohelm Navico 2500, AM/FM radio tape player, 27 Mhz radio.

Inventory: Meths 2 burner stove; 50l water bladder with deck filler, manual sink pump. Sealed gel batteries, solar panel. Lifejackets. Horseshoe lifebuoy. 2 anchors, chain and line (1 x CQR and 1 x Sand). Fire blanket, fire extinguishers. Cushions in excellent condition. Cockpit cushions. Porta potti. Fenders, fender board, docklines, manual bilge pump, 2 Barlow 15 halyard winches; 2 Barlow 16 sheet winches; 2 Winch handles

